

FEATURES

- 2.5" Extra deep box
- Red color for Fire Alarm
- 16 gauge steel
- 1/2" and 3/4" knockouts

DESCRIPTION

The Gemcom Surface Mount Back Box is a great solution for installing any of Gemcom's 2 Gang Switch Assemblies for a clean surface installation. The Back Box comes with four (4) mounting holes and pre-tapped holes for installation of 2 Gang Switch Assemblies.

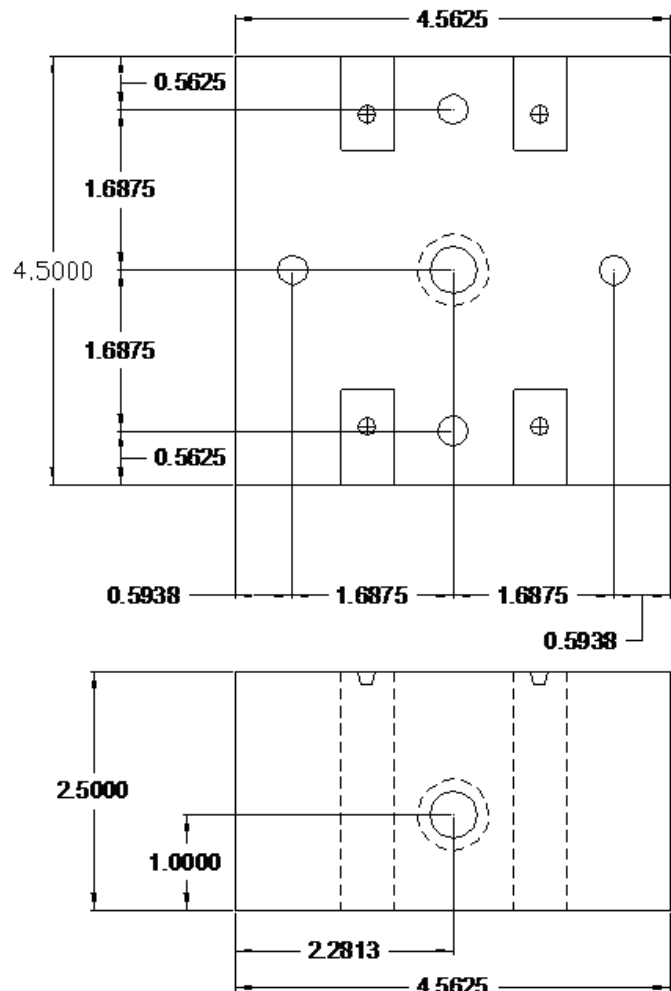

This literature is provided for informational purposes only. Gemcom, INC. assumes no responsibility for the product's suitability for a particular application. The product must be properly applied to work correctly. If you need more information on this product, or if you have a particular problem or question, contact GEMCOM, INC., WILLOW SPRINGS, IL 60480. Telephone: (708) 839-6840